

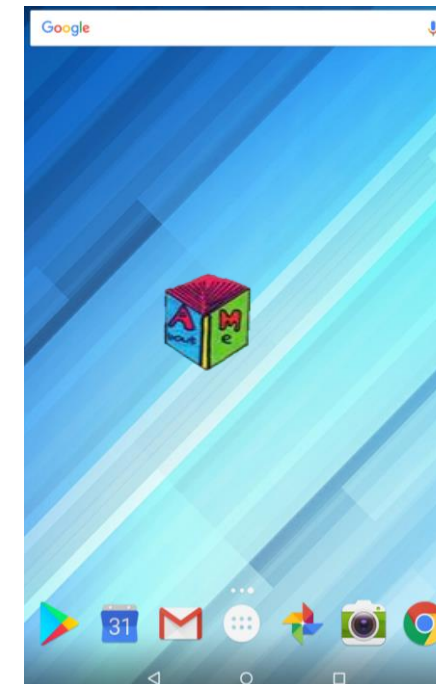

Simply Connecting People, Systems & Organisations



About Me - Autism App User Guide



Disclaimer Screen

This first screen is an introduction to the About Me App (Autism Passport). You will be prompted to accept the terms before proceeding any further.

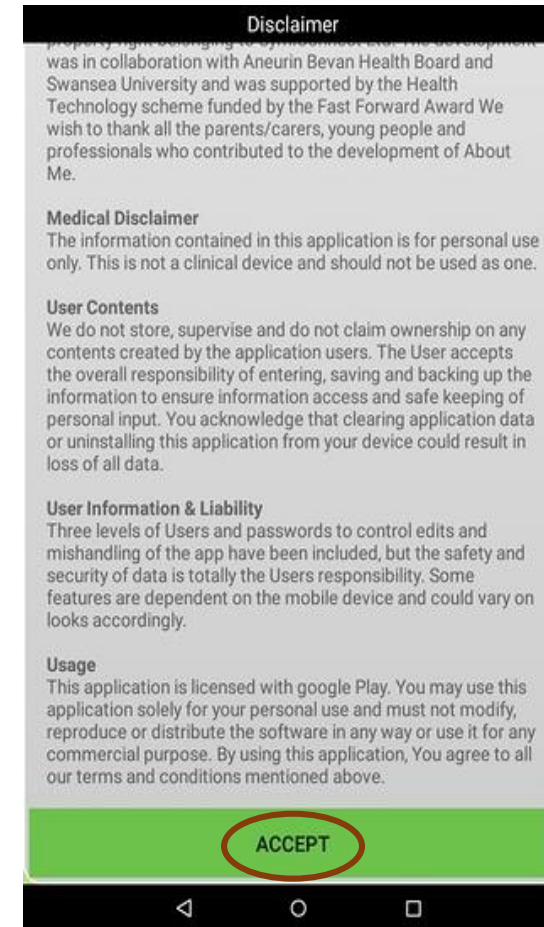
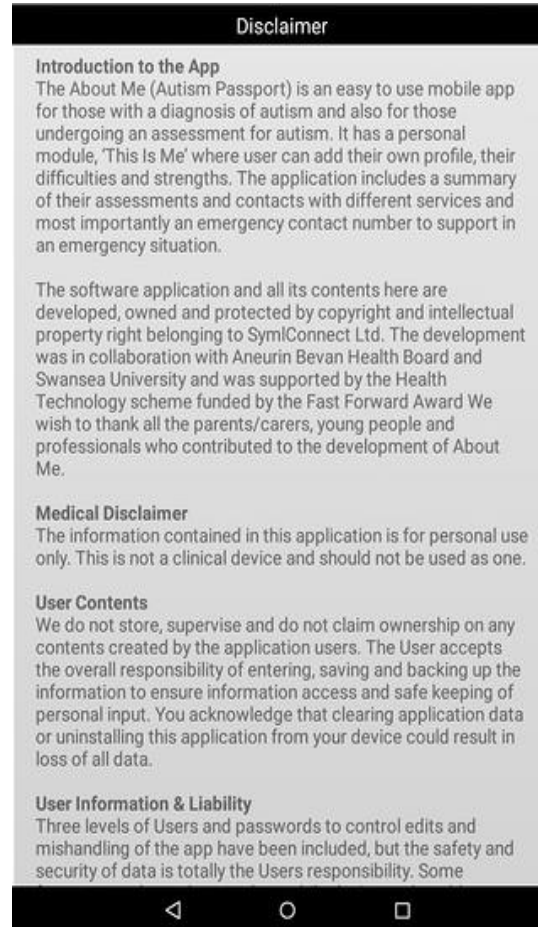

Password Alert Screen

Password
Alert

Please read and keep a copy of the information somewhere, so you can have it handy when needed.

This page won't be shown again.

For the first time Login you will be asked to use the System Manager Password (SMP) which will be in this screen.

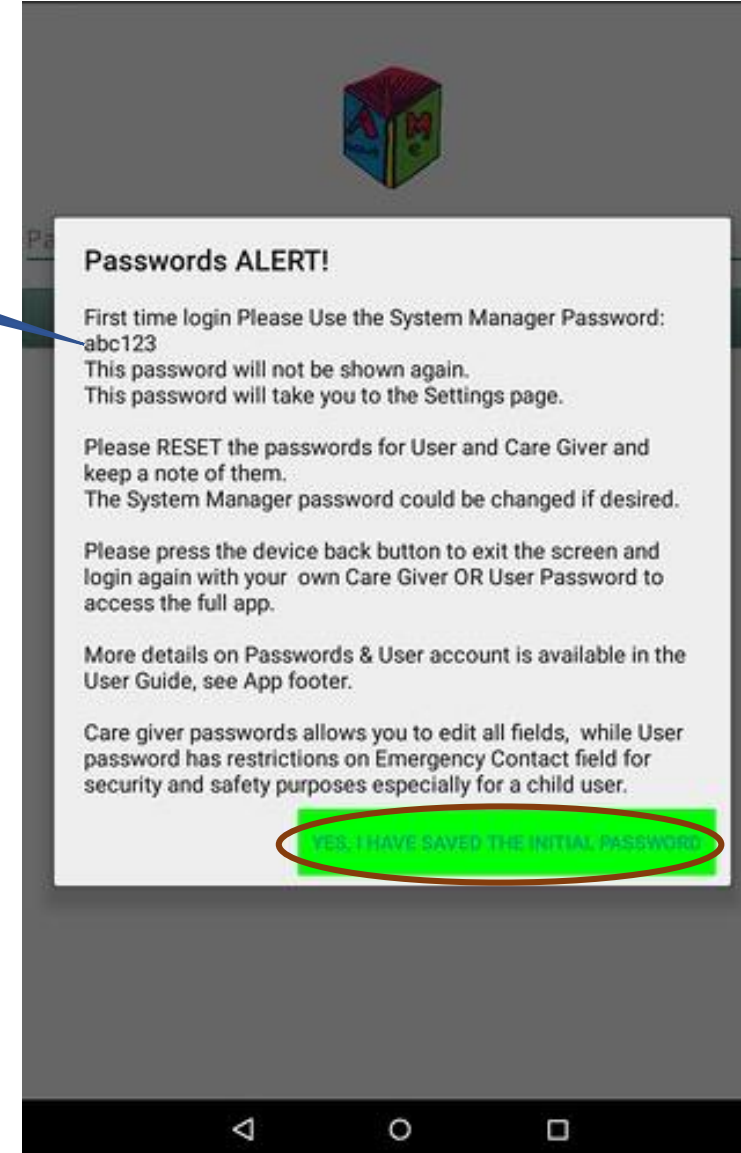

Personal Set Up Page

Here you can personalize your Greeting text e.g. 'Hello Autumn'

Set the User or Care Giver or System password according to your choice
You can alter it in the future, anytime you please.

You are now ready to login to your About Me app

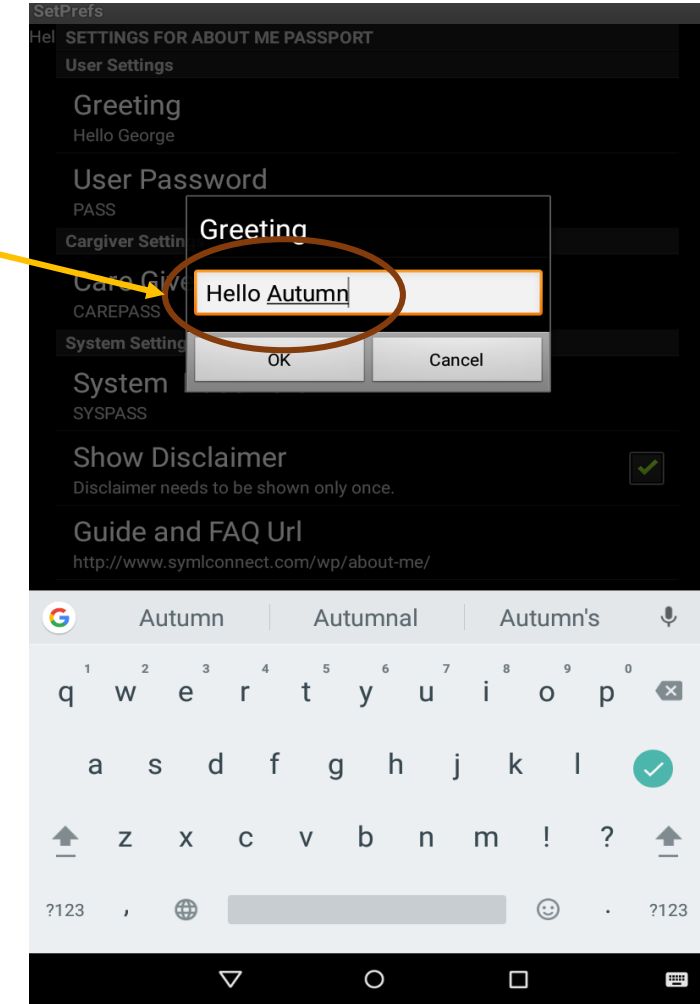
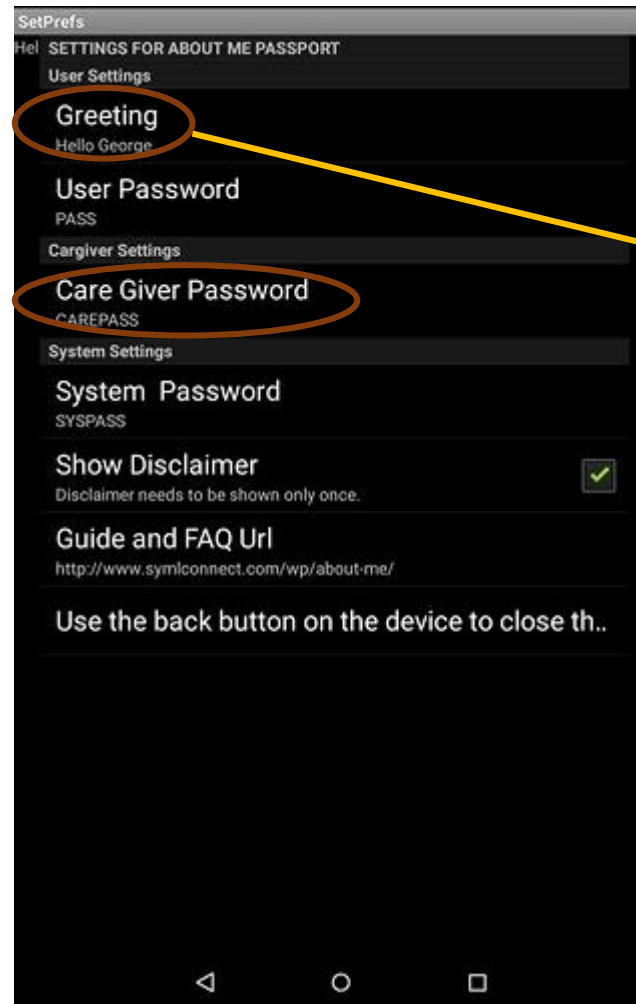

Unique Password Login

Login to your App
Using your own
password to open
Home Page.

Your
Password

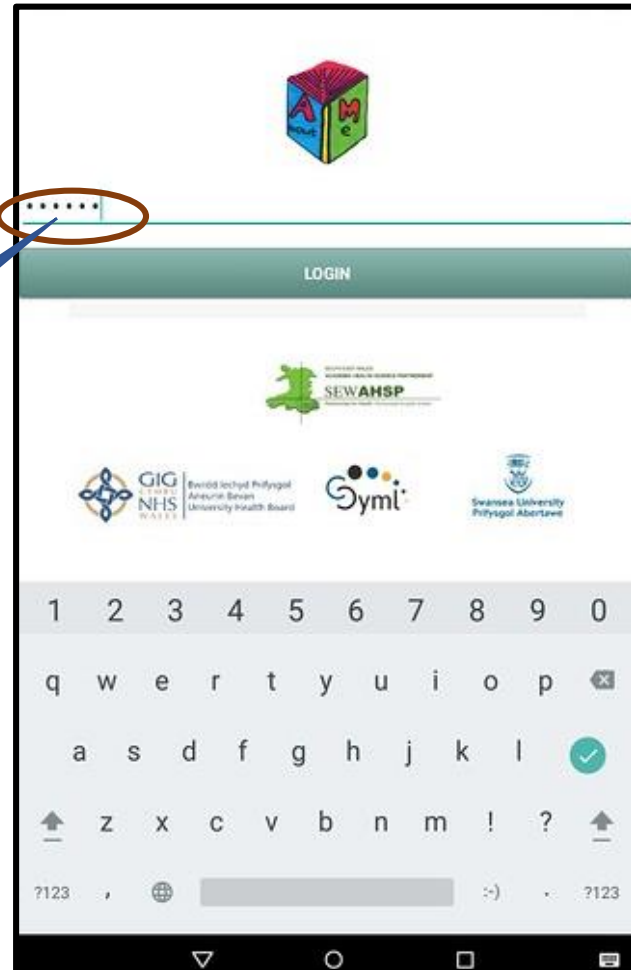

Your
Greetings



Login will open the Home Page.
You can click on any tab you wish

Home Page Functionalities



'This is Me' Tab Drop Down

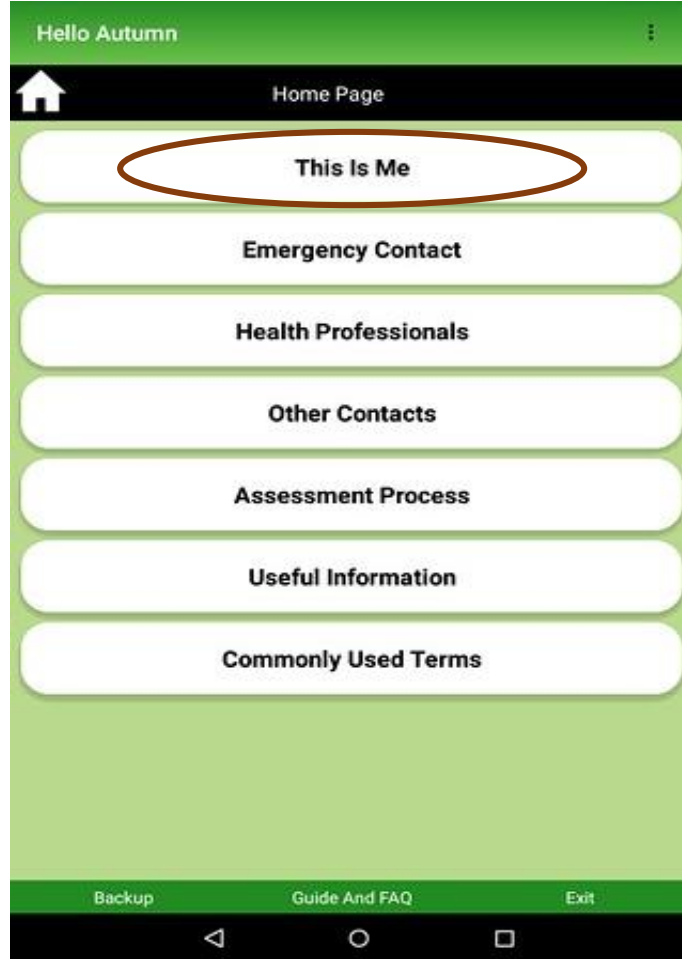

Click to go back to the Home Page anytime.

Click the 'This is Me' tab to open the sub sections. These sections are described in the following pages

'This is Me' Tab: What is Important to me?

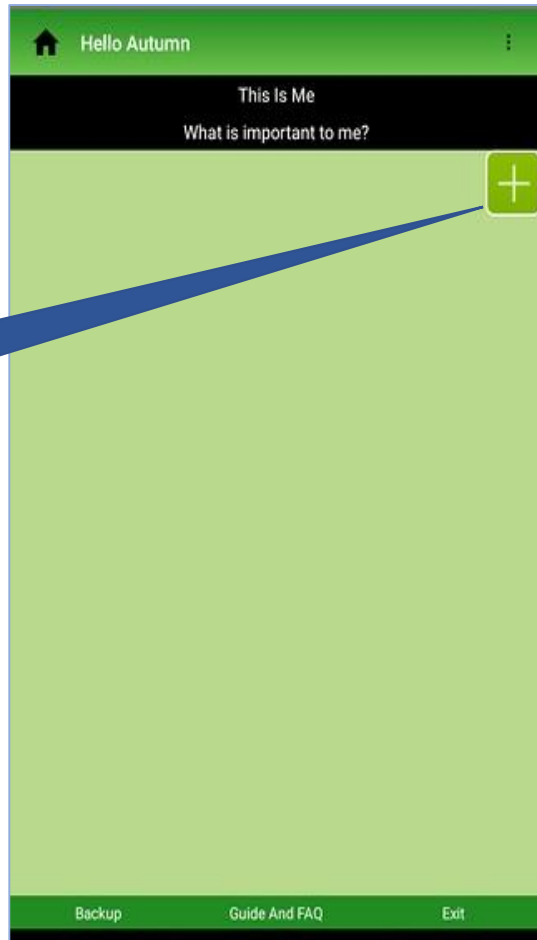

Click '+' to open entry box

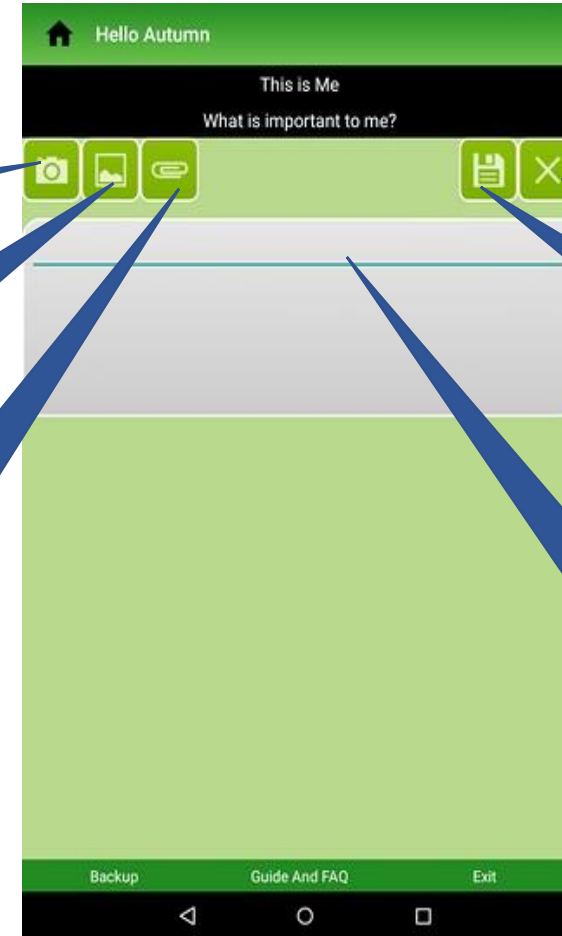

Camera Access

Click to attach a document

Allows you to access photos from your mobile device

Click to Close screen

Click to Save your Information

Data entry box – click for key board to appear

These icons have same functionalities in all screens.

'This is Me' Tab: Things I don't like

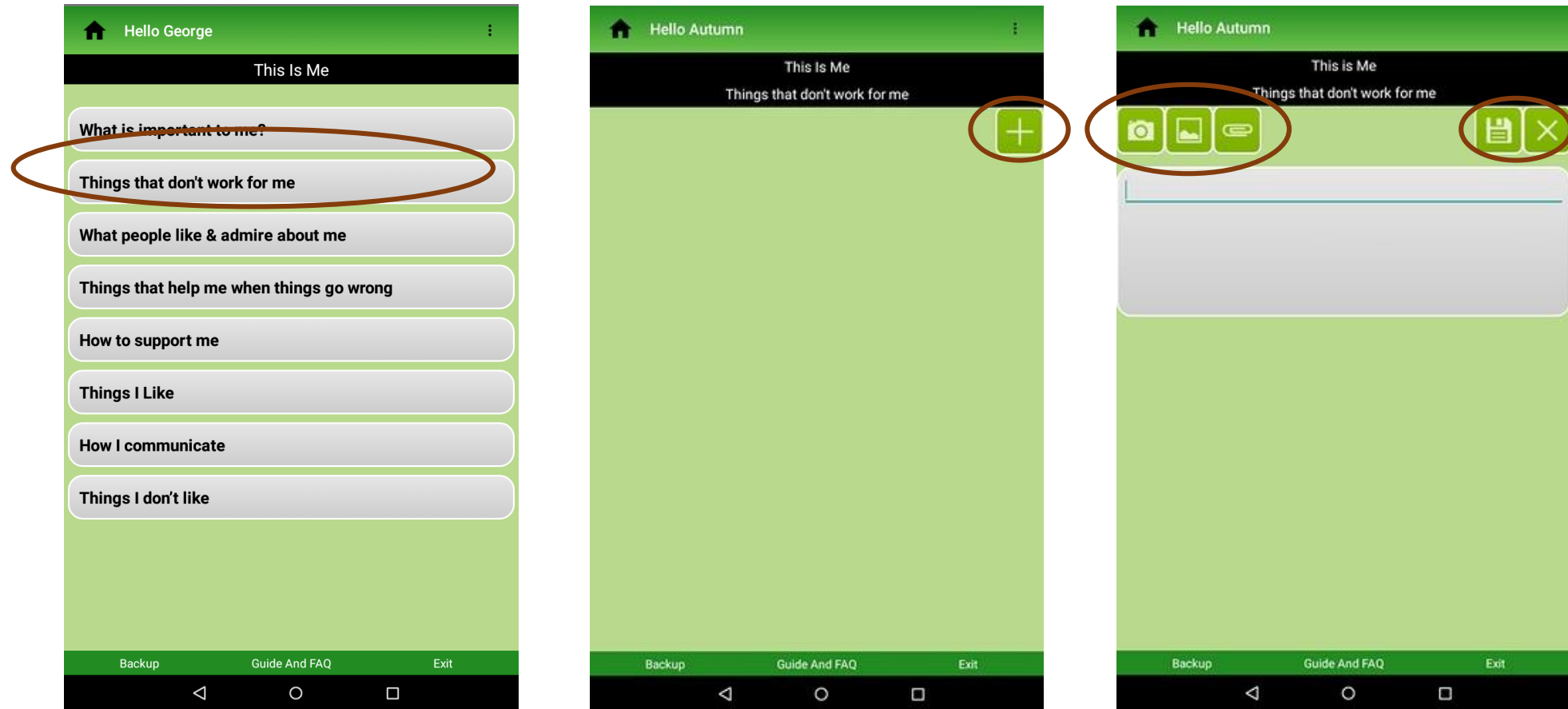

All Icons have same functionalities as previously explained.

'This is Me' Tab: What people like & admire about me.

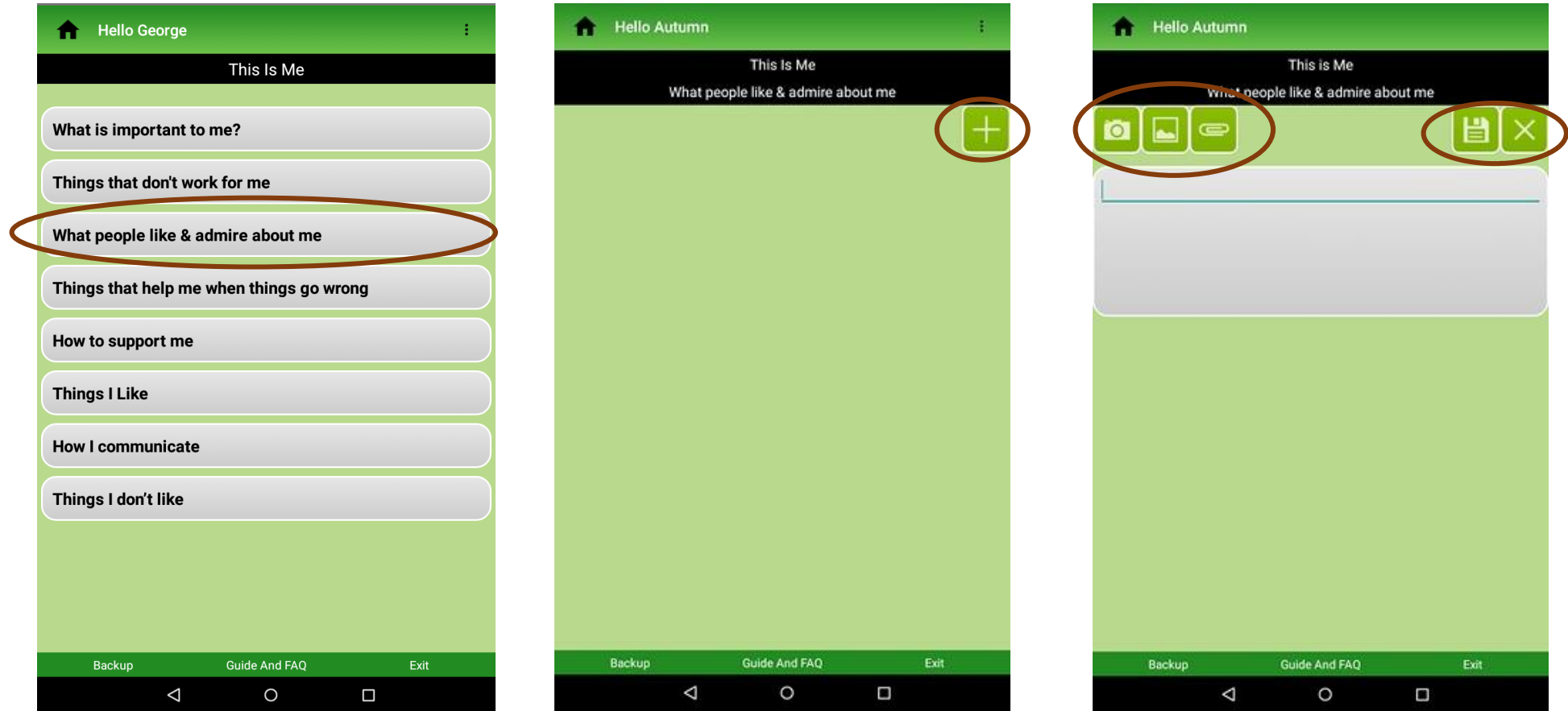

These icons have same functionalities in all tabs.

Emergency Contact Tab

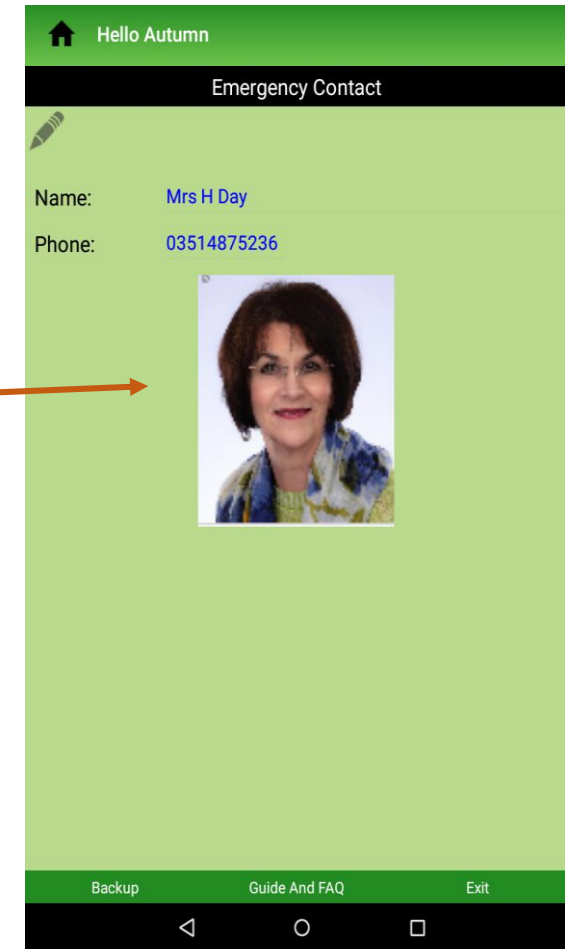
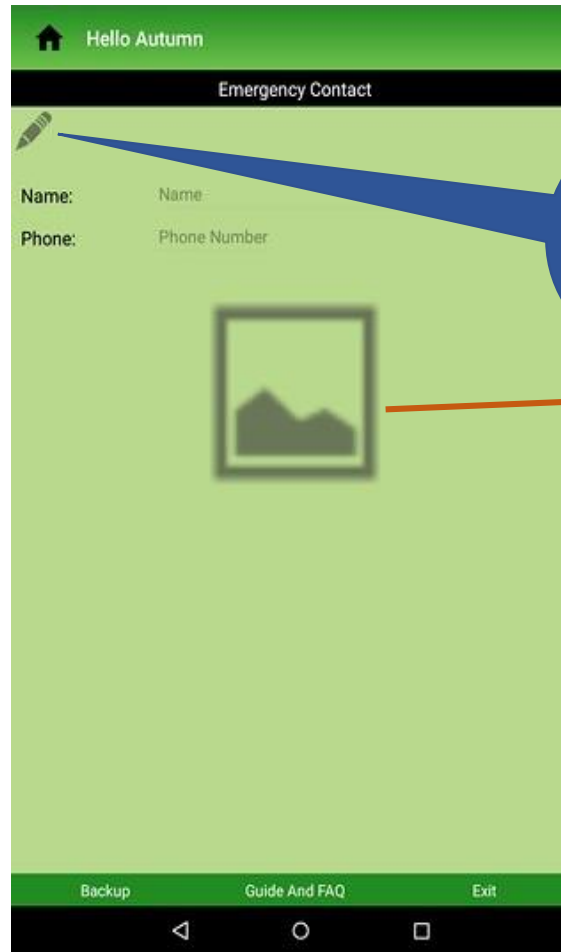

Click on the Picture icon to open your own gallery to attach the picture you want.

A complete Example

Health Professionals Tab

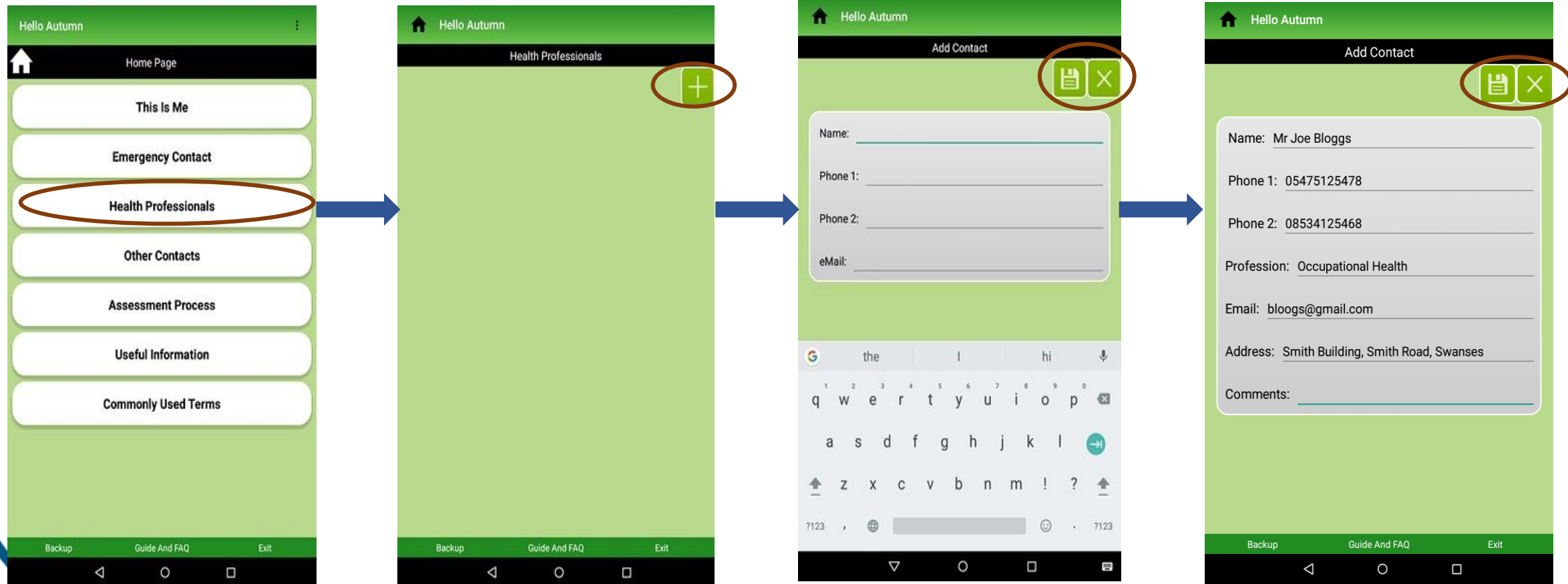

A completed Example.

Other Contacts Tab



PLEASE NOTE: 'Other Contact' details need the Care Giver to log in to add/edit
 Friends, Family and Educational Contact sub tabs work similarly as shown in this slide.

Assessment Process Tab

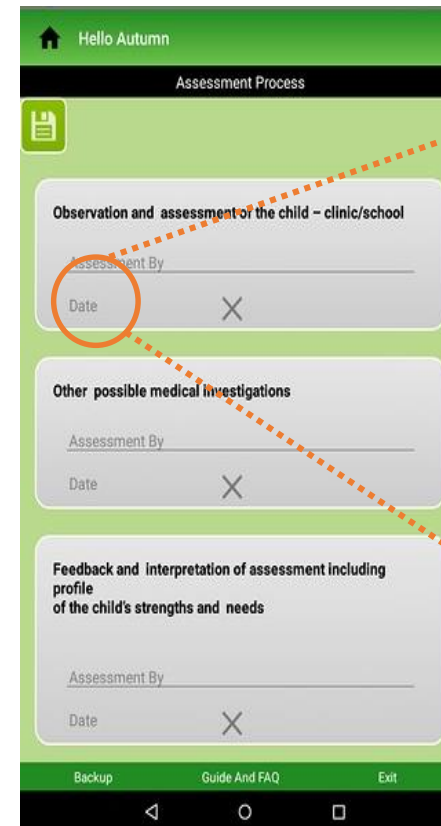
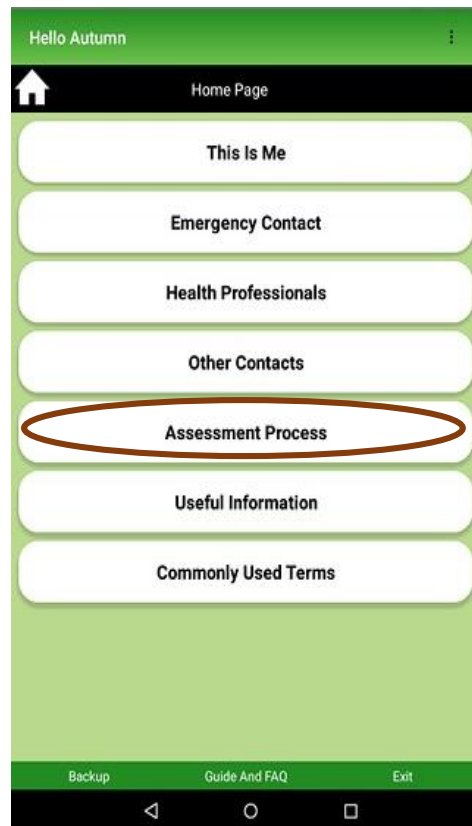

This tab opens a page where all the various appointments that you are likely to attend are listed. You can add the Name of the Doctor and Date for your own records and better understanding. Scroll down the page for more.

Useful Information Tab

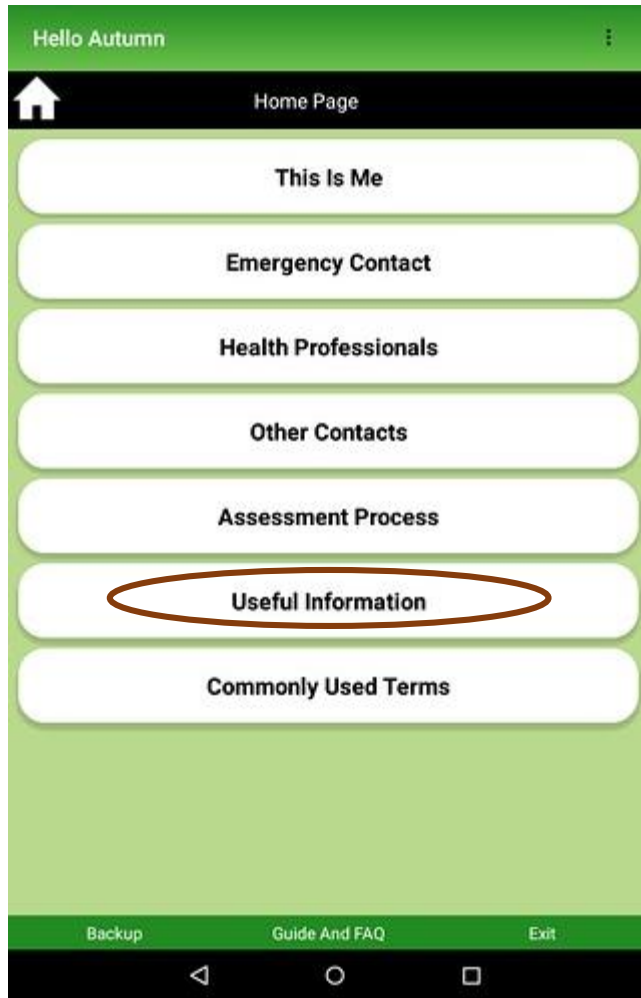

This is a Read-Only page with some useful website links. if you have wi fi on your mobile device you can open the links to learn more on this subject.

Commonly Used Terms Tab

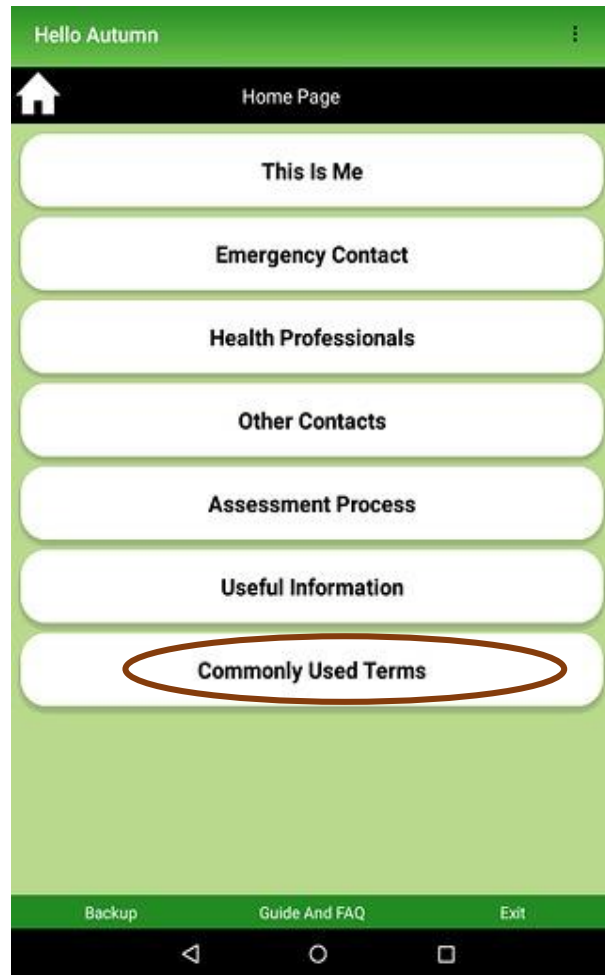

This is a Read Only page with some useful terms and clinical conditions which you might come across during your hospital visits. Scroll down for more info

Exit App



Home
Privacy Notice
Exit

Drop down menu
to exit app

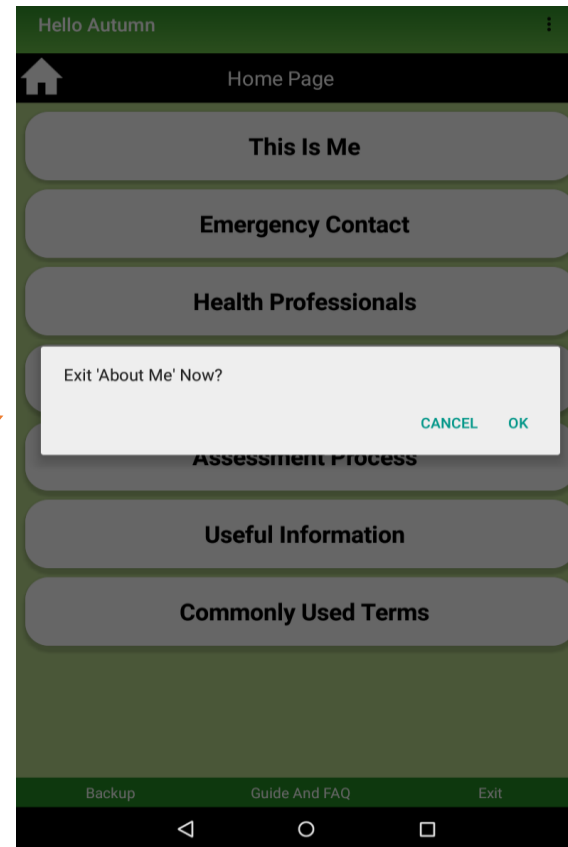

OR Click
to exit
app here



THANK YOU!



[@SymIConnect](https://twitter.com/SymIConnect)



[SymIConnect Limited](https://www.facebook.com/SymIConnectLimited)



[SymIConnect Limited](https://www.linkedin.com/company/SymIConnectLimited)



01792 60 6525



info@symlconnect.com



www.symlconnect.com